

# MP SERIES

Geared Traction Machine

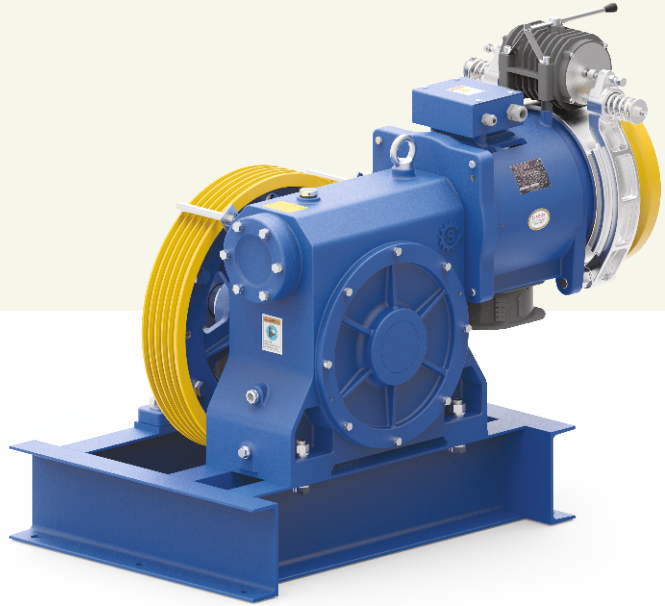

Static Load (kg)  
7000



Gear Ratio  
1/46



Oil Capacity (Ltr)  
10.0



Brake Voltage (DC)  
110V



Weight of Machine (kg)  
600\* (With Bed Plate)\*

\* Weight of machine is varies according to selection of sheave, Motor.

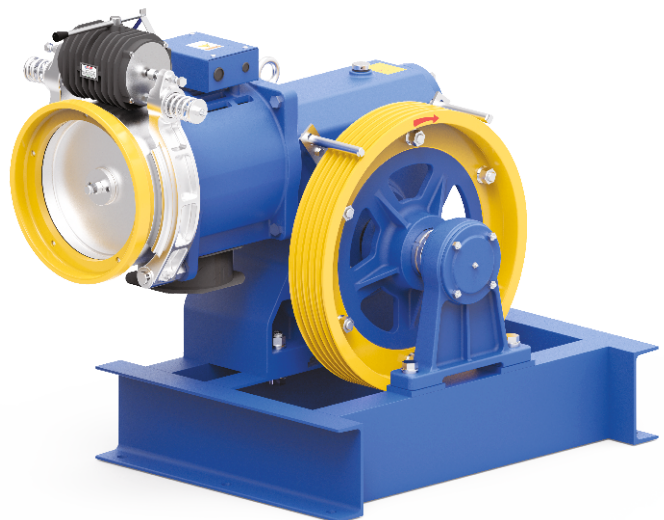

# Geared Traction Machine



Listed loads don't include the rope's weight.  
In order to know the net loads capacity, subtract rope's weight from the listed loads.

Position of the gearbox                      Up  
Counter weight                                50%  
Plant efficiency                                0.80

Machine	Duty Load		Roping	Async. Speed	Ratio	Motor Detail		RPM	Rated Current	Sheave Specification
	Person	Kg				(kw)	(HP)			
				(m/sec)			(Async.)	(A)	Sheave Dia x Rope Dia. X No. of Groove	
Tusker	20	1360	1:1	1.00	1/46	15.0	20.0	1455	29.9	Ø 600 X 13mm X 5 Grv.
	26	1768		1.00	1/46	18.5	25.0	1455	36.0	Ø 600 X 13mm X 6 Grv.
	2500		2:1	0.50	1/46	15.0	20.0	1455	29.9	Ø 600 X 13mm X 5 Grv.
	3000			0.50	1/46	15.0	20.0	1455	29.9	Ø 600 X 13mm X 5 Grv.

Kindly contact us for various speed and load combination

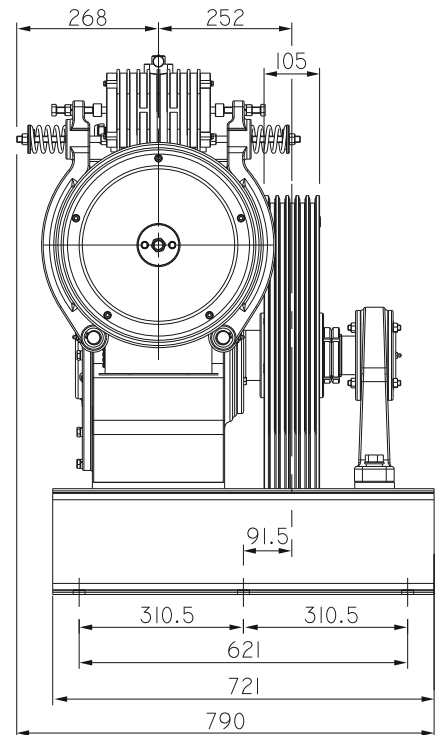
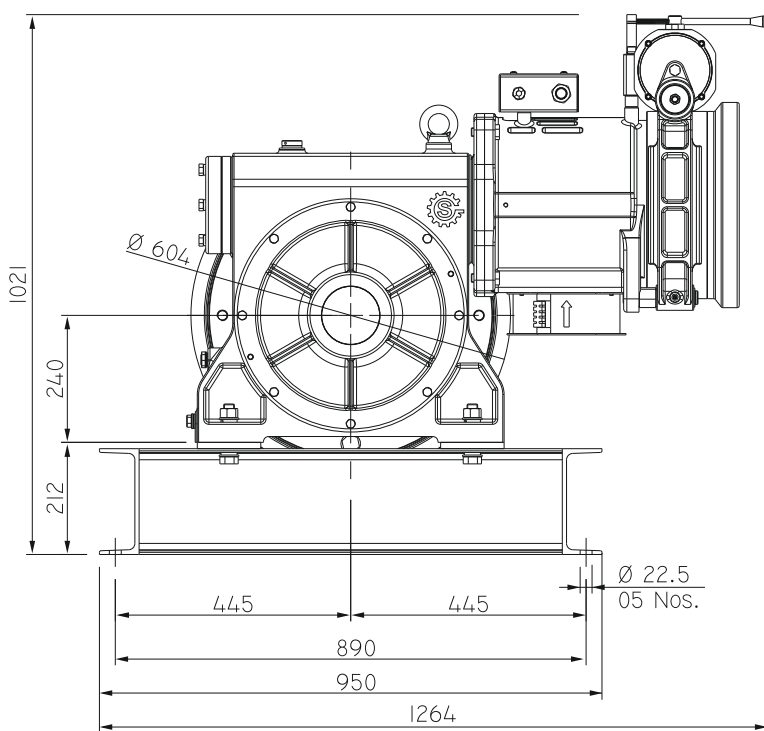

(All dimensions are in mm)