

[www.sharpengineers.com](http://www.sharpengineers.com)

# GEARED

Traction  
Machine

Technical Catalogues

The **Quality** Inspires Trust

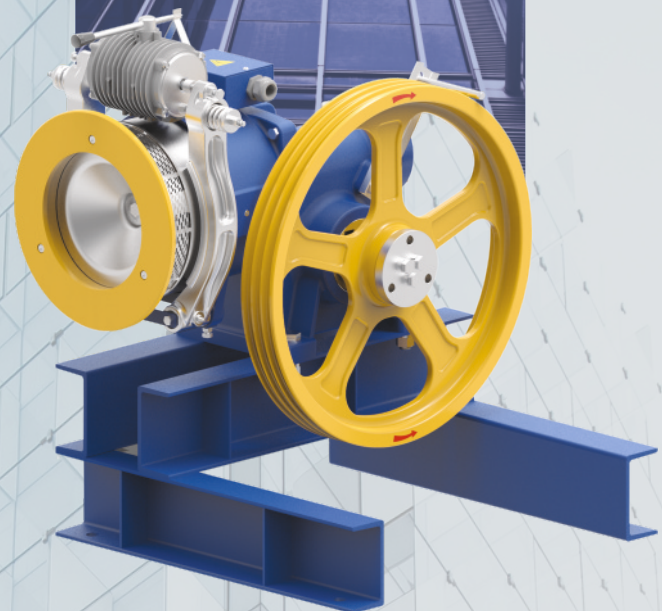

**SHARP**<sup>TM</sup>  
ENGINEERS

More than **35,000** Units Annual Production Capacity



**30**  
Years  
Journey to  
Excellence

## Company Profile

SHARP ENGINEERS, was established in 1994 in Ahmedabad (Gujarat) as a manufacturer of all kind of elevator traction machines for elevators. Sharp Engineers has an area of 81,000 sq. ft with their original asset of 200 employees and with the production capacity of more than 35000 units per annum. We always so much focused on the constant process of research and development to satisfy the need and comfort of the market. SHARP ENGINEERS have more than 30 years of experience, we developed over the years a complete range of products, geared and gearless machines. Sharp Engineers have optimized the meaning of Quality, Customer Service, after sales service and all other aspects concerned with creating a world class brand.



Our Production entirely made in Ahmedabad, equipped with the most innovative and efficient technical-productive solutions. Automation, efficiency, high technology which guarantees the production and supply of quality products in less time, which meets the needs of extreme speed and flexibility of the elevator market. Sharp engineers believes to provide the customer - best lifting solution according to their technical specifications of the system, starting from the activity of commercial technical support and continue throughout the production process to the final testing, in-line delivery with best industry standards and after sales service. We are exporting our ranges of Geared, Gearless & their parts worldwide over the 25 countries since decades. We have numerous special versions and options which are available on request.





Mr. Babubhai J Patel

SHARP ENGINEERS combines the advantages of a history of outstanding engineering skill in India with the rapid growth and attractive surrounding of elevator industry in India.

Our Main aim is to offer highest technical and quality level at best commercial conditions and to support you to run your business smoothly and successfully.

Managing Partner  
**SHARP ENGINEERS**



Mr. Mukesh R. Patel

SHARP ENGINEERS is focused on "providing the best possible all time support to customer in terms of new technology as per market scenario" We firmly believe that exploration will never stop, similar to the fact that people never stop their hopes and exploration for the sky.

Managing Partner  
**SHARP ENGINEERS**





## TECHNOLOGIES INNOVATION IS CENTRAL AT HOME SHARP ENGINEERS

Our world-class products improve performance and productivity. We have the global manufacturing capability and technical centers of excellence, each dedicated to developing and rigorously testing new high-performance products to meet precise industry and application needs.

We are continuously adapting new technology to innovate our new product development.

Because of this, we are able to help our customers to solve the world's greatest engineering challenges reliably, safely and efficiently.





C A U L D R O N   S E R I E S



### Quality Control System

"Customer Satisfaction" is main objective of Quality, providing best product & service with low cost and high Quality. All of our products, Test Reports and Certificates are granted by National Institute. Our all products possess many international certificates such as ISO 9001: 2015, CE (Europe), CSA (North America). The qualities of products are accepted by many high level companies in the Elevator industry.

### Quality Control Procedure

Our Quality Control Procedure includes various levels like Quality Management Department, Quality Control Department and Service Department. The Quality Management Department consists - QA Team and Measuring Room; while QC Department consists - Laboratory Quality Control and Testing Lab; and the Service Department consists the Service Center and On-site Service Team.



### After Sales Service

We specially design After Sales Service team to cater customers various demands in installation, maintenance and use of Elevator Traction Machine either Gear or Gearless. Our After Sales Service Team offers service supports within 24 hours from online feedback.



## CAULDRON SERIES

| Geared Traction Machine |

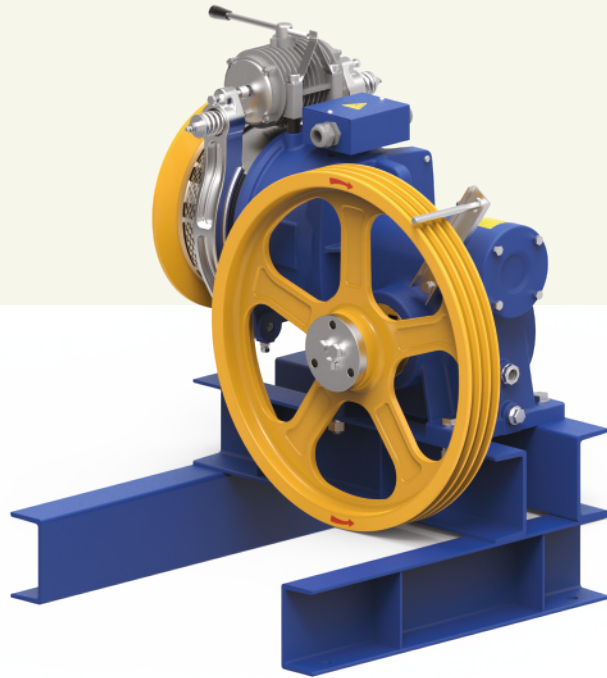

**Static Load (Kg)**  
2200



**Gear Ratio**  
1/37



**Brake Voltage (DC)**  
110V, 220V



**Oil Capacity (Ltr)**  
1.5



**Weight of Machine (kg)**  
180\* (With Bed Plate)\*

\* Weight of machine is varies according to selection of sheave, Motor & Drive system.

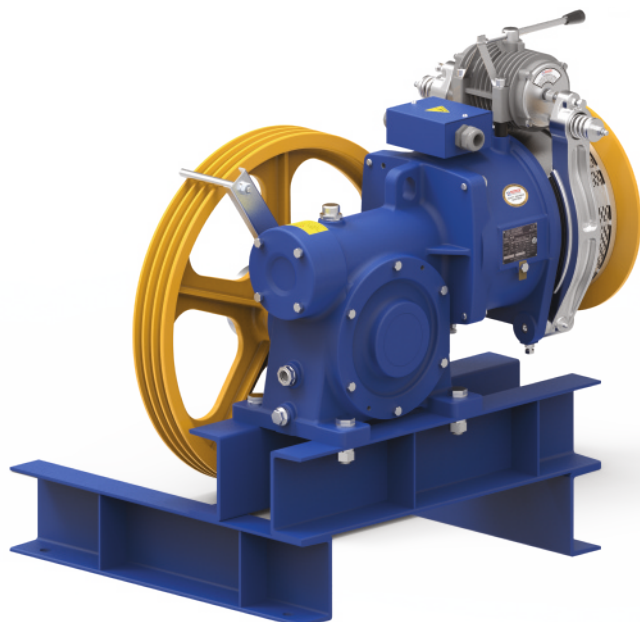





## Geared Traction Machine



Listed loads don't include the rope's weight.  
In order to know the net loads capacity, subtract rope's weight from the listed loads.

Position of the gearbox	Up
Counter weight	50%
Plant efficiency	0.80

AC VVVF			400 V		50 Hz		Travelling : - 21 mtr		
Machine	Duty Load		Roping	Async. Speed	Ratio	Motor Detail	RPM	Rated Current	Sheave Specification
	Person	Kg		(m/sec)		(kw)	(Async.)	(A)	Sheave Dia x Rope Dia. X No. of Groove
STARK	6	408	1:1	1.00	1/37	4.0	1430	9.0	Ø 530 X 13mm X 3 Grv.
				0.70	1/37	4.0	1430	9.0	Ø 320 X 8mm X 5 Grv.

Kindly contact us for various speed and load combination

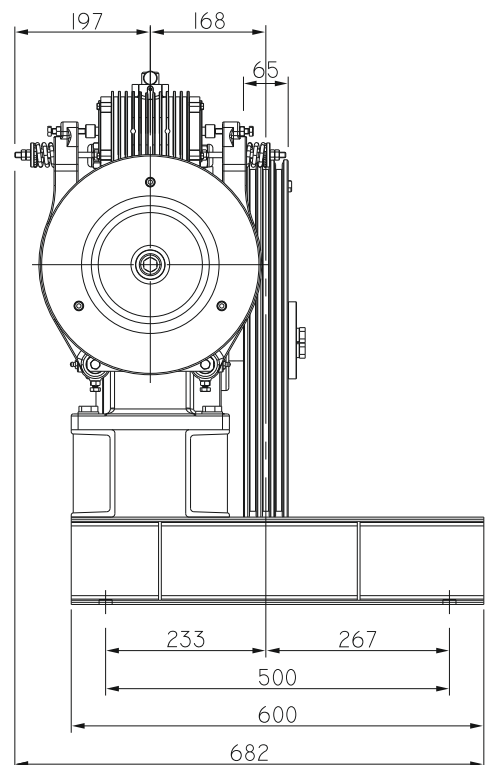
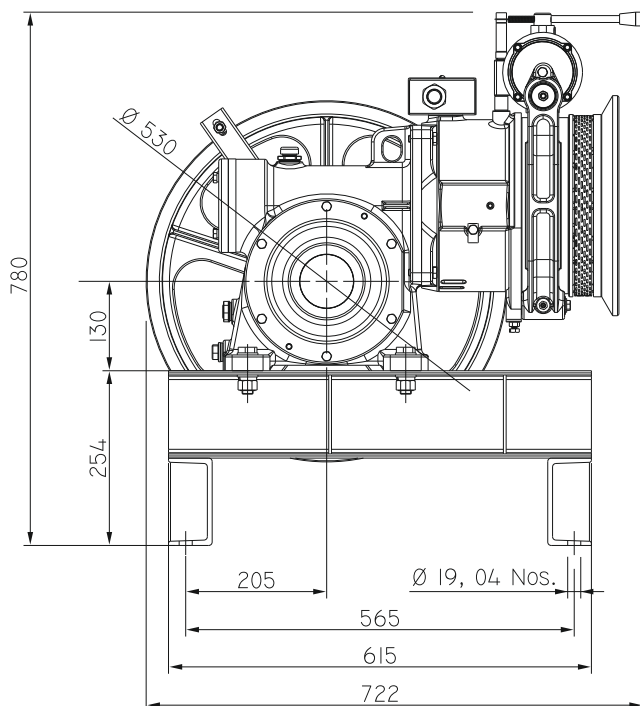

(All dimensions are in mm)



## CAULDRON SERIES

| Geared Traction Machine |

*Stellar*  
**125**

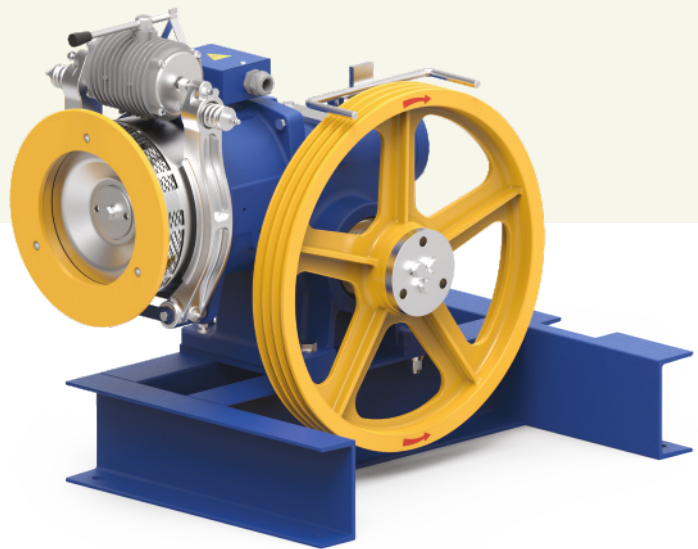

**Static Load (kg)**  
3000



**Gear Ratio**  
1/41



**Oil Capacity (Ltr)**  
2.0



**Brake Voltage (DC)**  
110V, 220V



**Weight of Machine (kg)**  
204\*

\* Weight of machine is varies according to selection of sheave, Motor & Drive system.

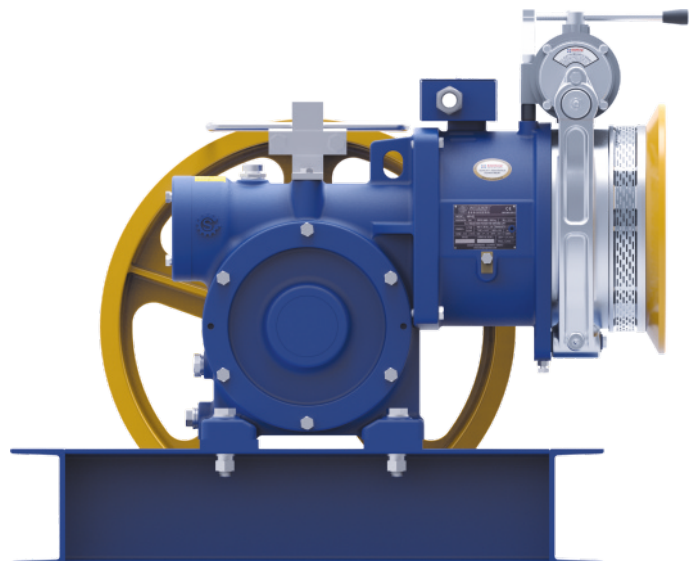



## Geared Traction Machine

*Stellar*  
**125**

Listed loads don't include the rope's weight.  
In order to know the net loads capacity, subtract rope's weight from the listed loads.

Position of the gearbox Up  
Counter weight 50%  
Plant efficiency 0.80

AC VVVF			400 V			50 Hz			Travelling : - 30 mtr	
Machine	Duty Load		Roping	Async. Speed	Ratio	Motor Detail		RPM	Rated Current	Sheave Specification
	Person	Kg		(m/sec)		(kw)	(HP)	(Async.)	(A)	Sheave Dia x Rope Dia. X No. of Groove
STELLAR - 125	6	408	1:1	0.70	1/41	3.7	5.0	930	8.8	Ø 530 X 13mm X 3 Grv.
				1.00	1/41	4.5	6.0	1430	9.2	Ø 530 X 13mm X 3 Grv.

Kindly contact us for various speed and load combination

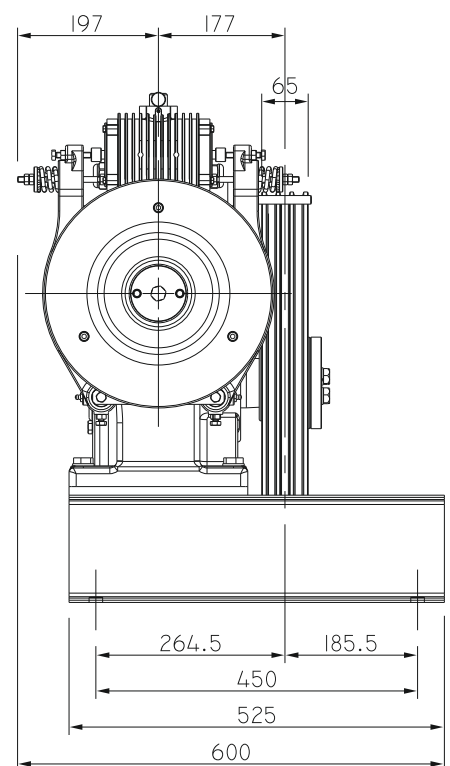
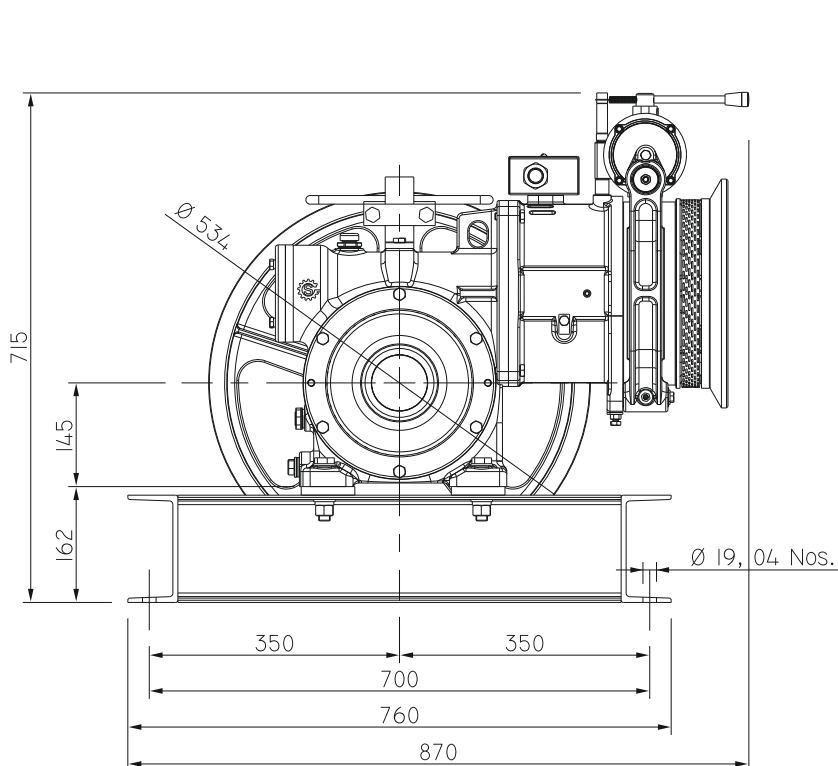

(All dimensions are in mm)



## CAULDRON SERIES

| Geared Traction Machine |

*Stellar*  
**125-R1**

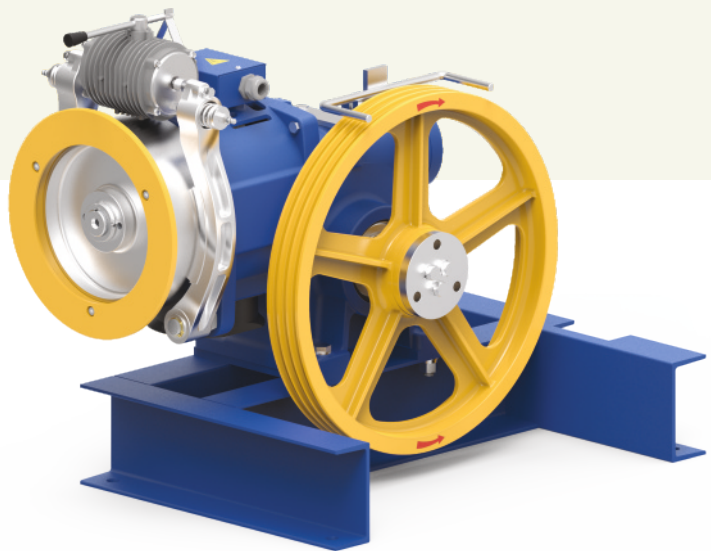

**Static Load (Kg)**  
3000



**Gear Ratio**  
1/41



**Brake Voltage (DC)**  
110V, 220V



**Oil Capacity (Ltr)**  
2.0



**Weight of Machine (kg)**  
240\* (With Bed Plate)\*

\* Weight of machine is varies according to selection of sheave, Motor & Drive system.

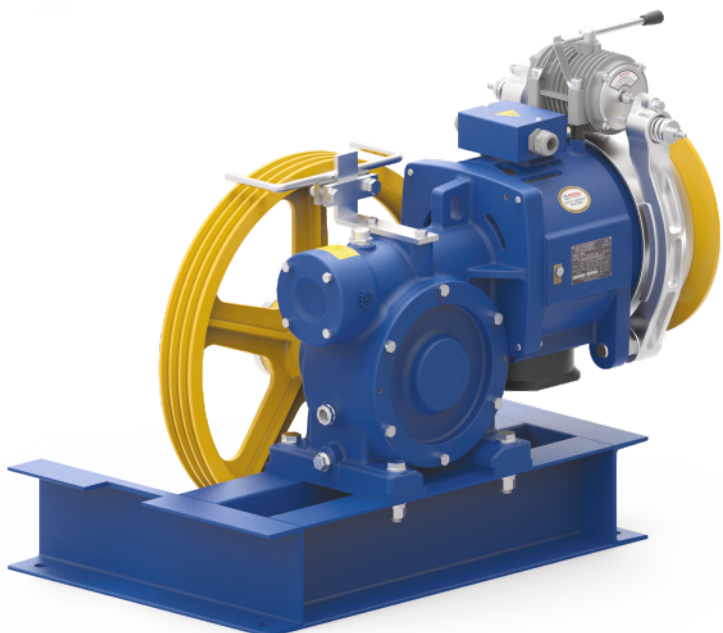



## Geared Traction Machine

*Stellar*  
**125-R1**

Listed loads don't include the rope's weight.  
In order to know the net loads capacity, subtract rope's weight from the listed loads.

Position of the gearbox	Up
Counter weight	50%
Plant efficiency	0.80

AC VVVF			400 V			50 Hz			Travelling : - 30 mtr	
Machine	Duty Load		Roping	Async. Speed	Ratio	Motor Detail		RPM	Rated Current	Sheave Specification
	Person	Kg		(m/sec)		(kW)	(HP)		(A)	Sheave Dia x Rope Dia. X No. of Groove
Staller 125 - R1	8	544	1:1	1.00	1/41	5.5	7.5	1455	11.5	Ø 530 x 13mm x 3 Grv

Kindly contact us for various speed and load combination

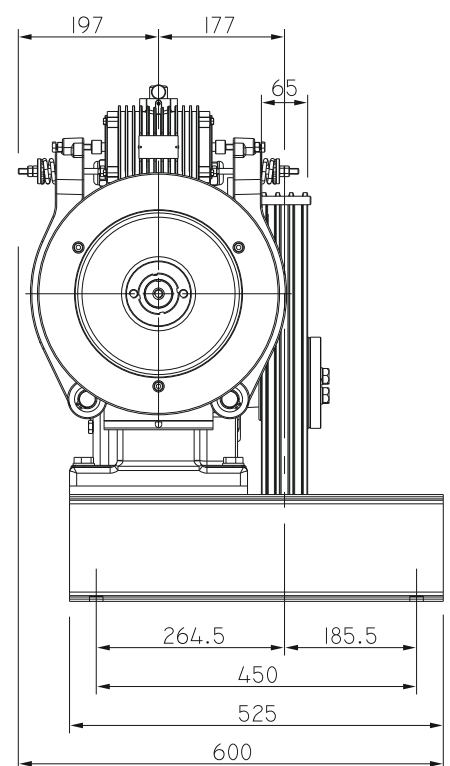
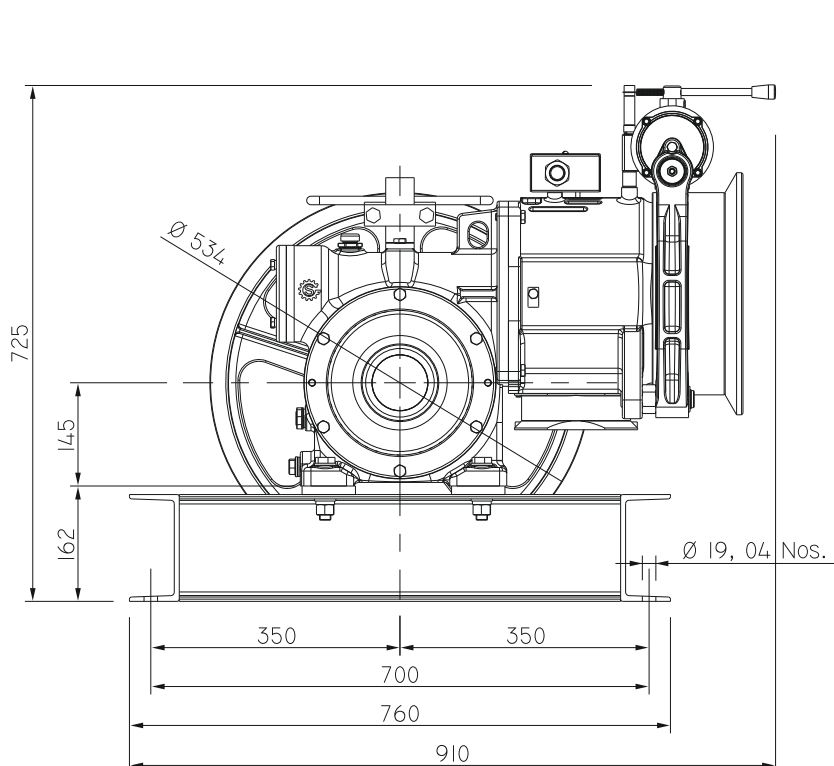

(All dimensions are in mm)



## CAULDRON SERIES

| Geared Traction Machine |

 CAULDRON<sup>®</sup>-125 N

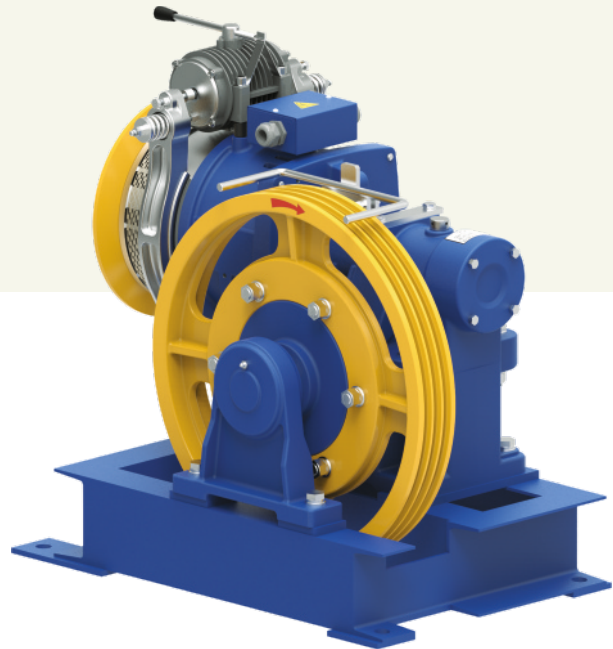

**Static Load (kg)**  
3000



**Gear Ratio**  
1/41



**Oil Capacity (Ltr)**  
3.0



**Brake Voltage (DC)**  
110V, 220V



**Weight of Machine (kg)**  
238\*

\* Weight of machine is varies according to selection of sheave, Motor & Drive system.

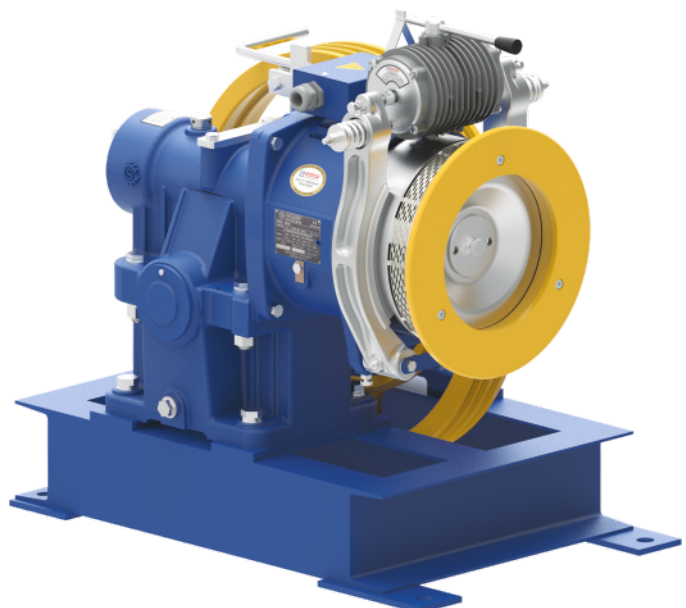



## Geared Traction Machine



Listed loads don't include the rope's weight.  
In order to know the net loads capacity, subtract rope's weight from the listed loads.

Position of the gearbox Up  
Counter weight 50%  
Plant efficiency 0.80

AC VVVF			400 V			50 Hz			Travelling : - 30 mtr	
Machine	Duty Load		Roping	Async. Speed	Ratio	Motor Detail		RPM	Rated Current	Sheave Specification
	Person	Kg		(m/sec)		(kw)	(HP)	(Async.)	(A)	Sheave Dia x Rope Dia. X No. of Groove
CAL - 125N	6	408	1:1	0.70	1/41	3.7	5.0	930	8.8	Ø 530 X 13mm X 3 Grv.
				1.00	1/41	4.5	6.0	1430	9.2	Ø 530 X 13mm X 3 Grv.
	8	544		1.00	1/41	5.5	7.5	1455	11.5	Ø 530 X 13mm X 3 Grv.

Kindly contact us for various speed and load combination

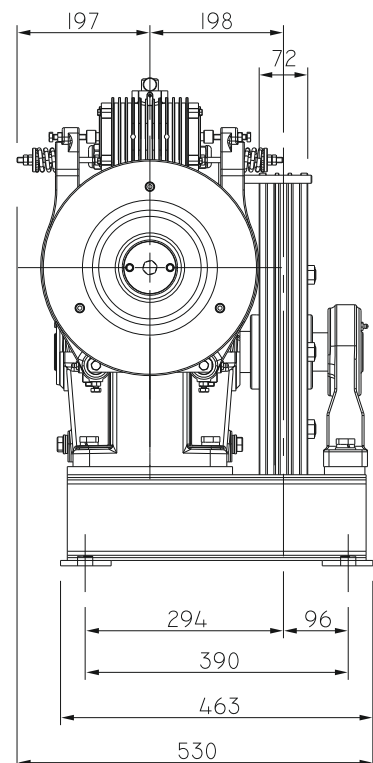
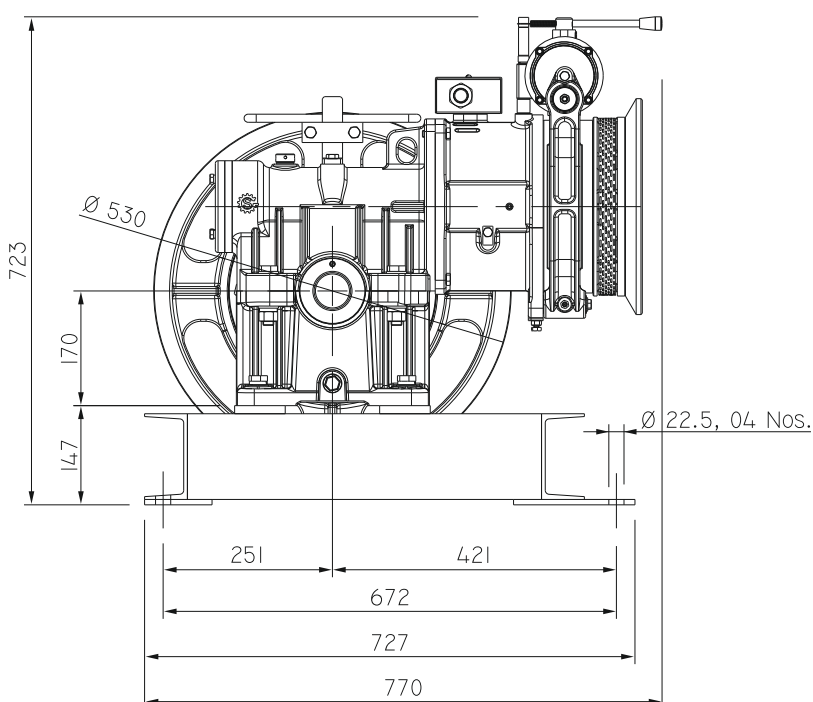

(All dimensions are in mm)



## CAULDRON SERIES

| Geared Traction Machine |

**CAULDRON<sup>®</sup>-135N**

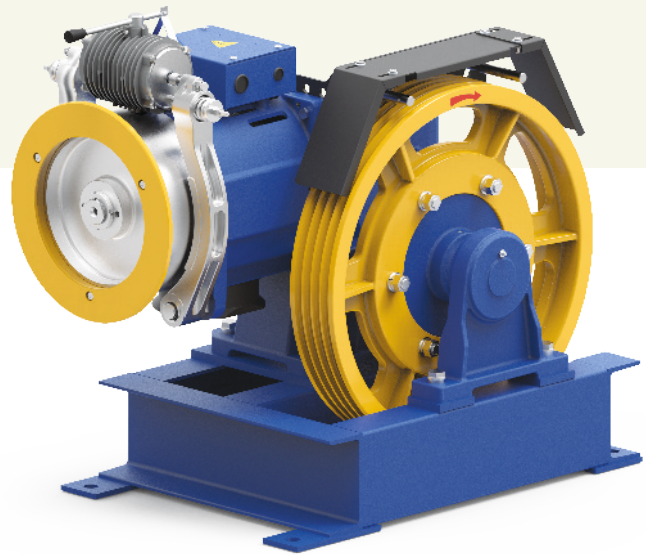

**Static Load (kg)**  
3800



**Gear Ratio**  
1/45



**Oil Capacity (Ltr)**  
3.5



**Brake Voltage (DC)**  
110V, 220V



**Weight of Machine (kg)**  
310\*

\* Weight of machine is varies according to selection of sheave, Motor.

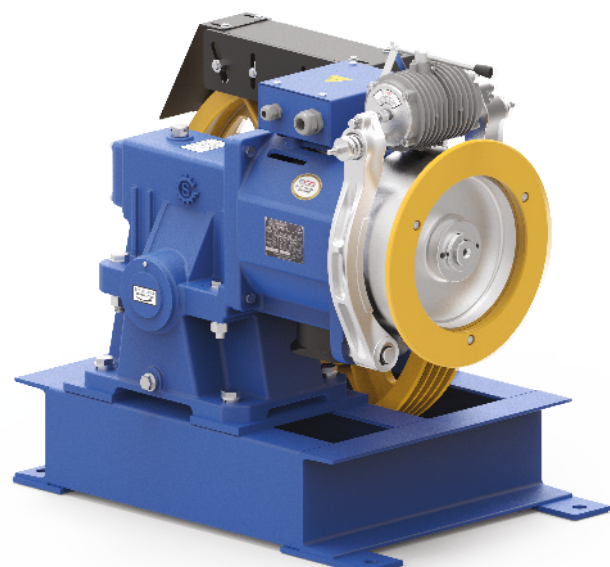

## Geared Traction Machine



Listed loads don't include the rope's weight.  
In order to know the net loads capacity, subtract rope's weight from the listed loads.

Position of the gearbox Up  
Counter weight 50%  
Plant efficiency 0.80

AC VVVF			400 V		50 Hz		Travelling : - 30 mtr			
Machine	Duty Load		Roping	Async. Speed	Ratio	Motor Detail		RPM	Rated Current	Sheave Specification
	Person	Kg		(m/sec)		(kw)	(HP)	(Async.)	(A)	Sheave Dia x Rope Dia. X No. of Groove
CAL - 135N	10	680	1:1	1.00	1/45	7.5	10.0	1423	14.5	Ø 560 X 13mm X 4 Grv.
	1000		2:1	0.50	1/45	5.5	7.5	1455	11.5	Ø 560 X 13mm X 3 Grv.

Kindly contact us for various speed and load combination

ØP	A	B	C	D
Ø530 - Ø560	72	224	326.5	106.5
Ø530 - Ø560	92	222	324.5	108.5

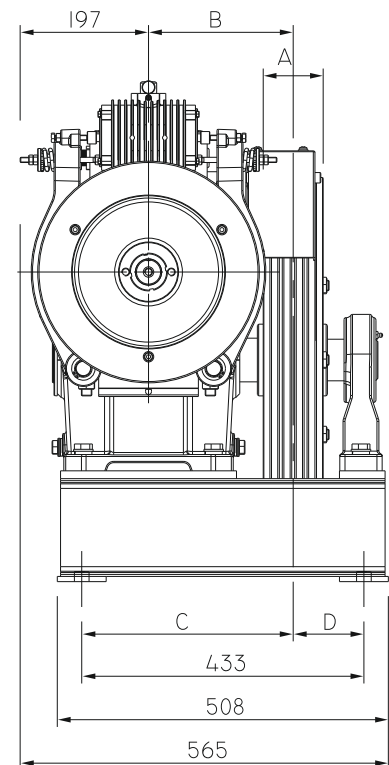
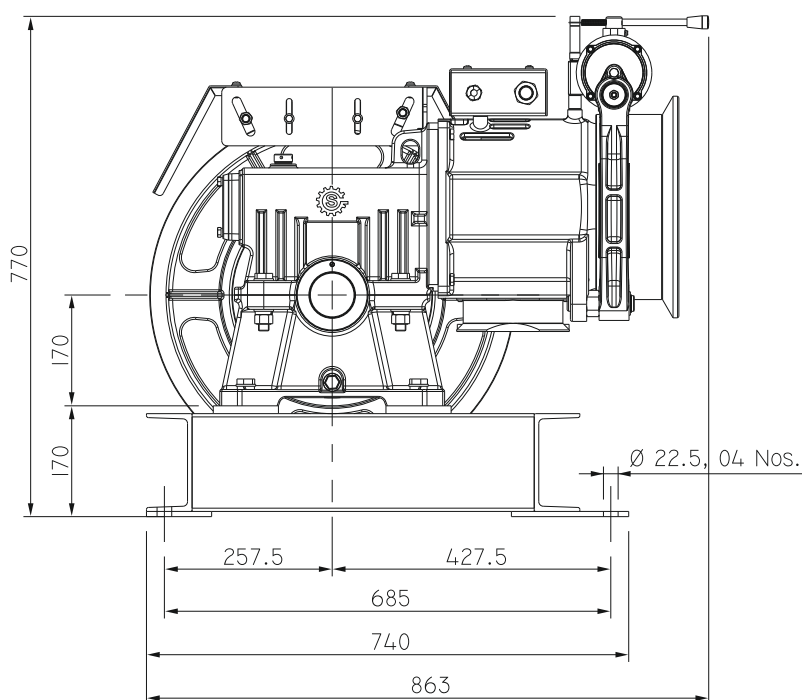

(All dimensions are in mm)



## CAULDRON SERIES

| Geared Traction Machine |

**CAULDRON<sup>®</sup>-150**

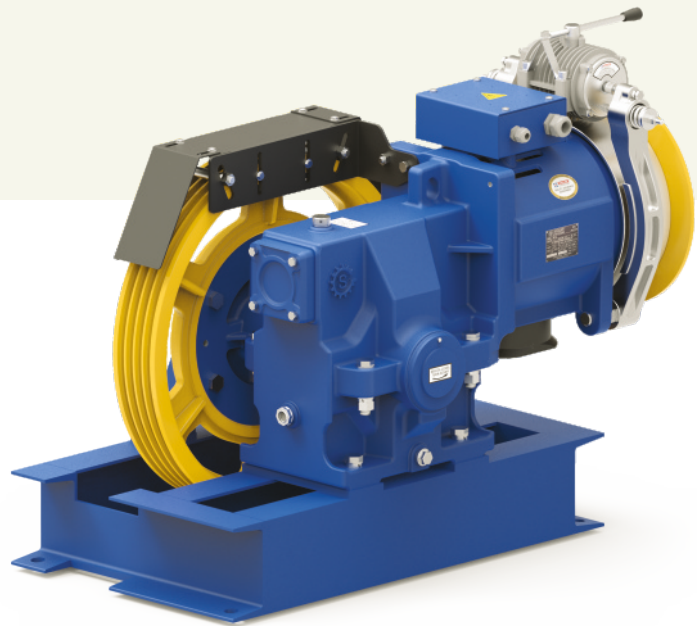

**Static Load (kg)**  
4000



**Gear Ratio**  
1/49, 1/59



**Oil Capacity (Ltr)**  
4.0



**Brake Voltage (DC)**  
110V, 220V



**Weight of Machine (kg)**  
341\*

\* Weight of machine is varies according to selection of sheave, Motor.



## Geared Traction Machine

### CAULDRON<sup>®</sup>-150

Listed loads don't include the rope's weight.  
In order to know the net loads capacity, subtract rope's weight from the listed loads.

Position of the gearbox Up  
Counter weight 50%  
Plant efficiency 0.80

AC VVVF			400 V		50 Hz			Travelling : - 30 mtr		
Machine	Duty Load		Roping	Async. Speed	Ratio	Motor Detail		RPM	Rated Current	Sheave Specification
	Person	Kg		(m/sec)		(kw)	(HP)			Sheave Dia x Rope Dia. X No. of Groove
CAL- 150	13	884	1:1	0.70	1/59	7.5	10.0	1423	14.5	Ø 530 X 13mm X 4 Grv.
				1.00	1/49	9.0	12.5	1458	20.5	Ø 610 X 13mm X 4 Grv.
	1500		2:1	0.32	1/59	6.7	9.0	1445	13.5	Ø 530 X 13mm X 4 Grv.
				0.50	1/49	7.5	10.0	1423	14.5	Ø 610 X 13mm X 4 Grv.

Kindly contact us for various speed and load combination

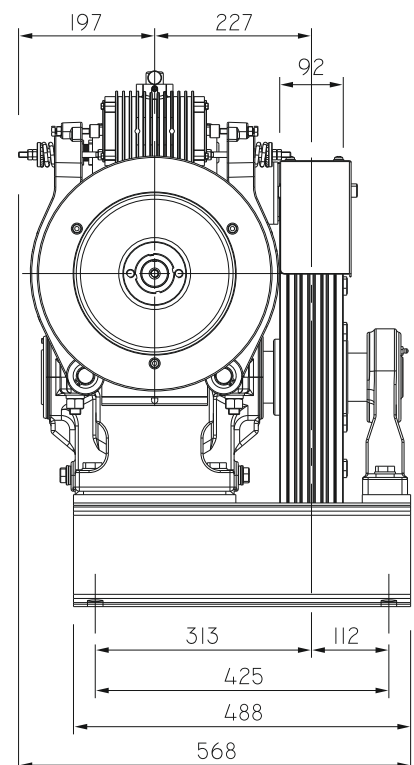
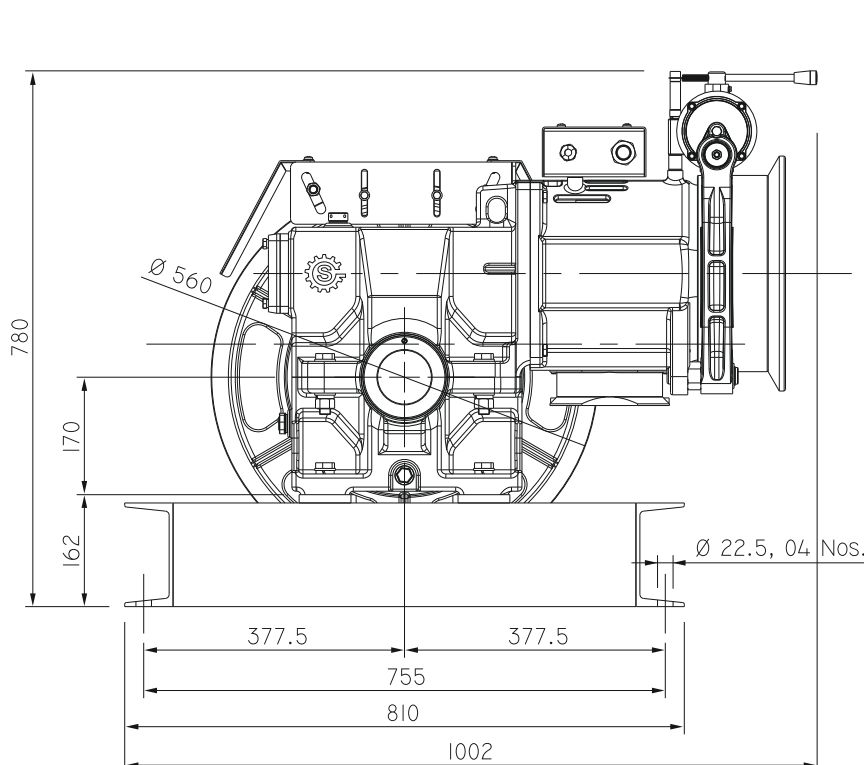

(All dimensions are in mm)

## CAULDRON SERIES

| Geared Traction Machine |

**CAULDRON<sup>®</sup>-165N**

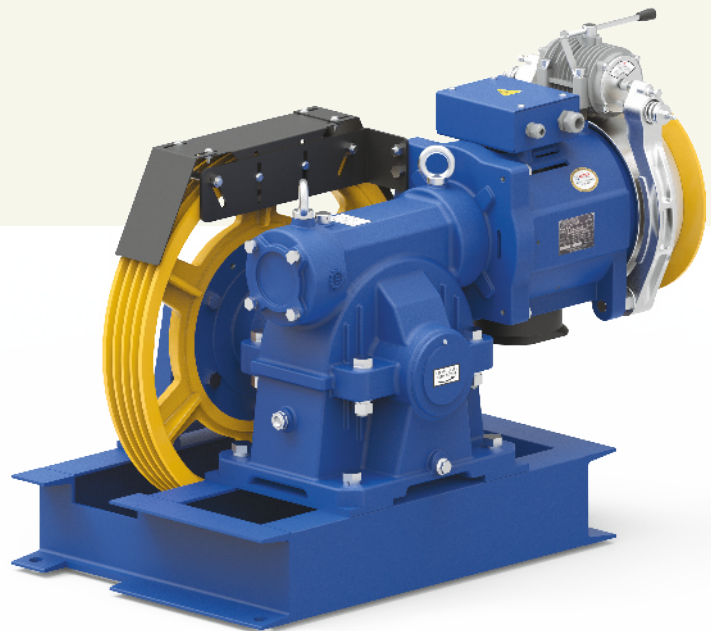

**Static Load (kg)**  
5000



**Gear Ratio**  
1/46



**Oil Capacity (Ltr)**  
6.0



**Brake Voltage (DC)**  
110V, 220V



**Weight of Machine (kg)**  
520\*

\* Weight of machine is varies according to selection of sheave, Motor.

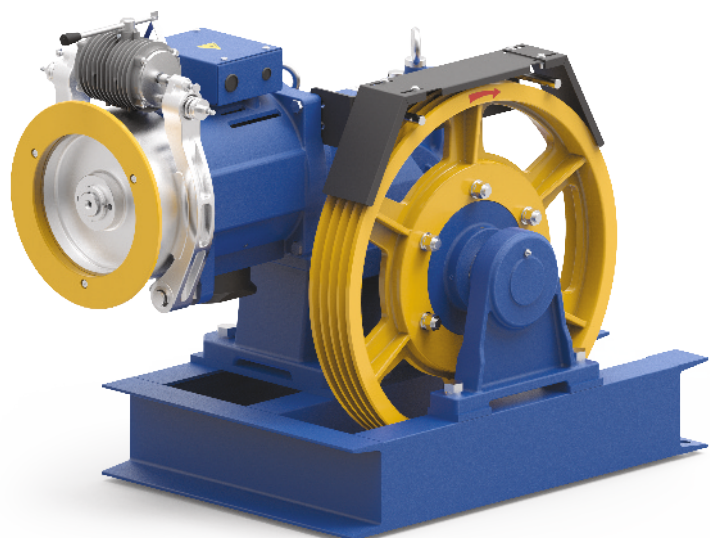



## Geared Traction Machine



Listed loads don't include the rope's weight.  
In order to know the net loads capacity, subtract rope's weight from the listed loads.

Position of the gearbox Up  
Counter weight 50%  
Plant efficiency 0.80

AC VVVF			400 V			50 Hz			Travelling : - 30 mtr	
Machine	Duty Load		Roping	Async. Speed	Ratio	Motor Detail		RPM	Rated Current	Sheave Specification
	Person	Kg		(m/sec)		(kw)	(HP)			Sheave Dia x Rope Dia. X No. of Groove
CAL - 165N	16	1088	1:1	1.00	1/46	11.0	15.0	1440	22.0	Ø 610 X 13mm X 4 Grv.
	2000		2:1	0.50	1/46	11.0	15.0	1440	22.0	Ø 610 X 13mm X 4 Grv.

Kindly contact us for various speed and load combination

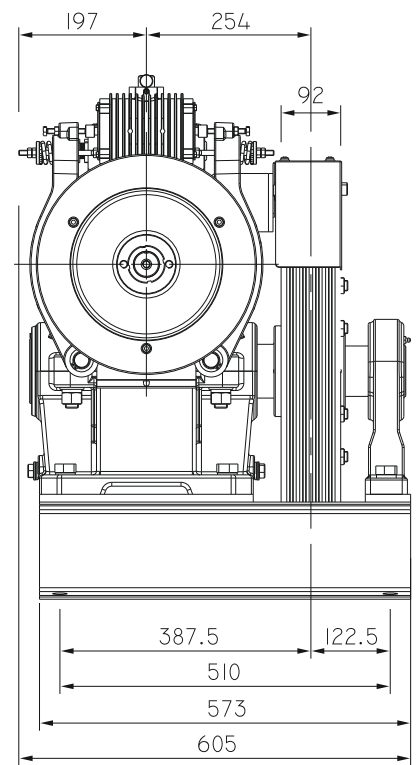
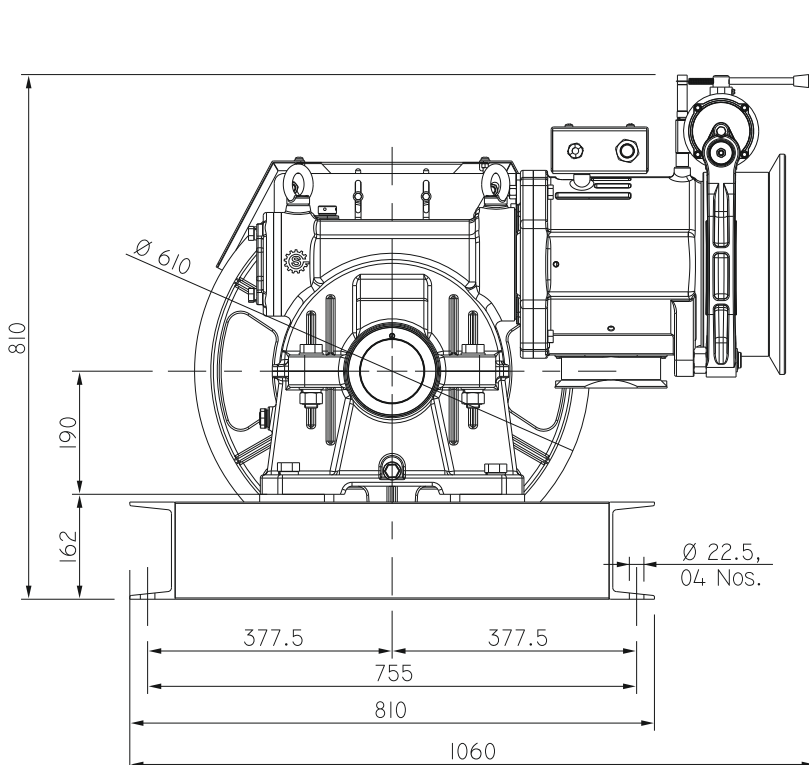

(All dimensions are in mm)

## CAULDRON SERIES

| Geared Traction Machine |

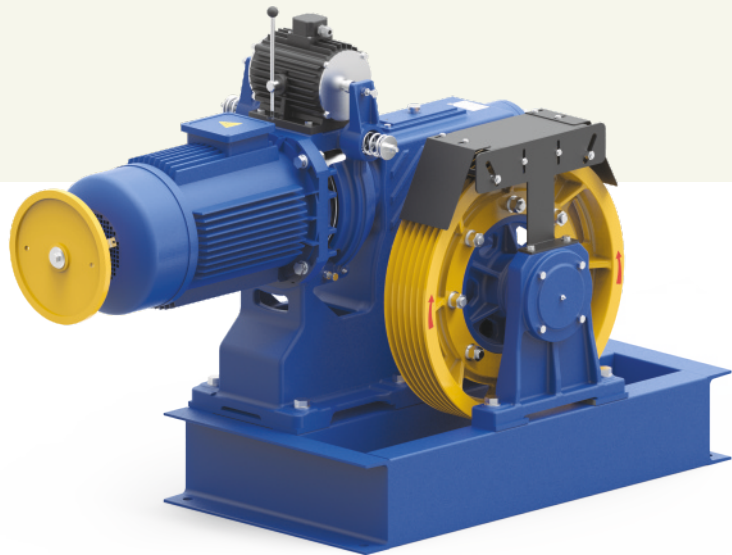

**Static Load (kg)**  
7000



**Gear Ratio**  
1/46



**Oil Capacity (Ltr)**  
10.0



**Brake Voltage (DC)**  
110V



**Weight of Machine (kg)**  
722\*

\* Weight of machine is varies according to selection of sheave, Motor.

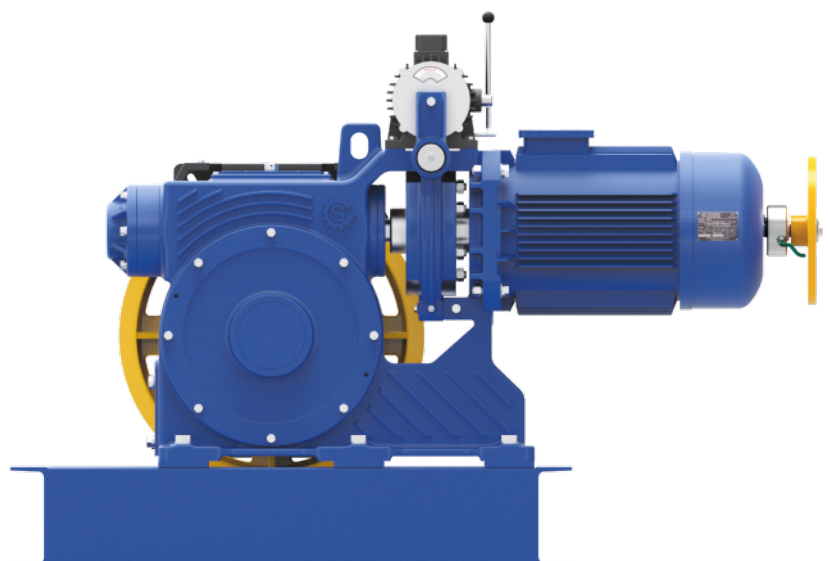

## Geared Traction Machine



Listed loads don't include the rope's weight.  
In order to know the net loads capacity, subtract rope's weight from the listed loads.

Position of the gearbox Up  
Counter weight 50%  
Plant efficiency 0.80

AC VVVF			400 V			50 Hz		Travelling : - 30 mtr		
Machine	Duty Load		Roping	Async. Speed	Ratio	Motor Detail		RPM	Rated Current	Sheave Specification
	Person	Kg		(m/sec)		(kw)	(HP)	(Async.)	(A)	Sheave Dia x Rope Dia. X No. of Groove
CAL - 200	20	1360	1:1	1.00	1/46	15.0	20.0	1440	29.9	Ø 610 X 13mm X 5 Grv.
	26	1768		1.00	1/46	18.5	25.0	1440	36.0	Ø 610 X 13mm X 6 Grv.
	2500		2:1	0.50	1/46	15.0	20.0	1440	29.9	Ø 610 X 13mm X 5 Grv.
	3000			0.50	1/46	15.0	20.0	1440	29.9	Ø 610 X 13mm X 5 Grv.

Kindly contact us for various speed and load combination

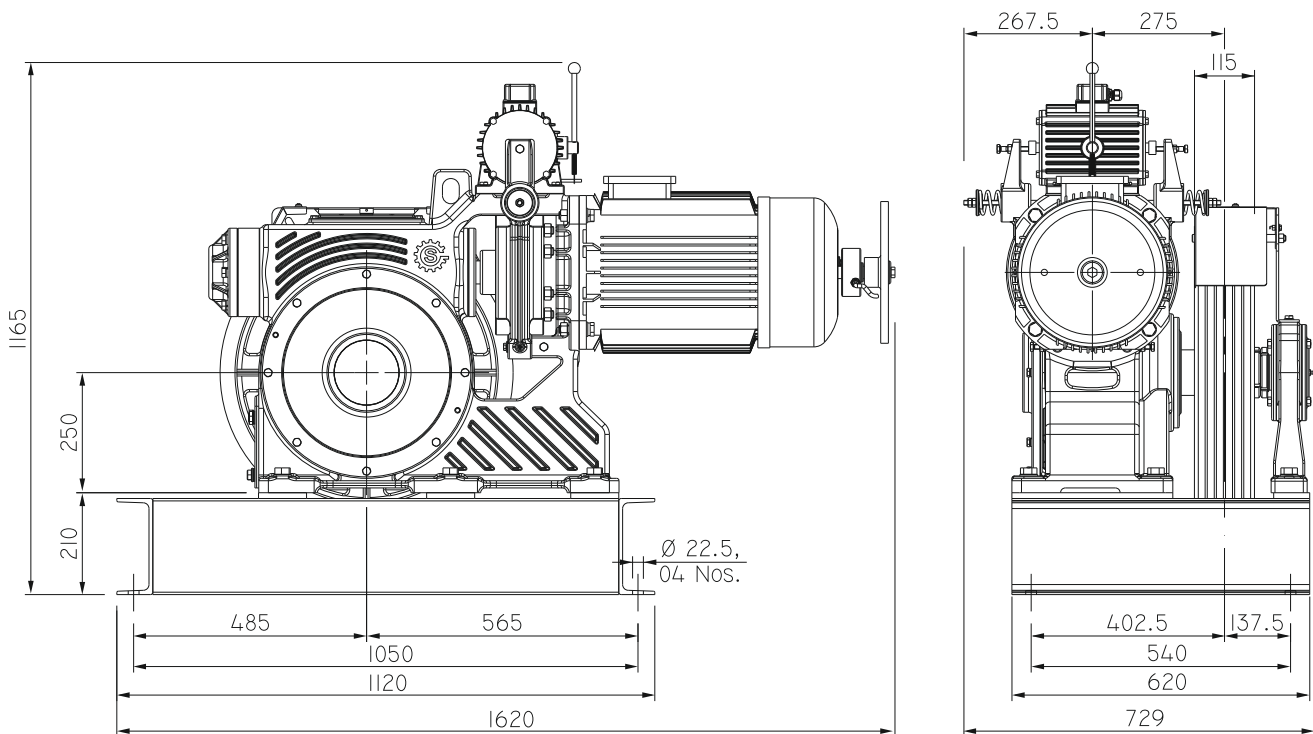

(All dimensions are in mm)

## CAULDRON SERIES

| Geared Traction Machine |

**CAULDRON<sup>®</sup>-250**

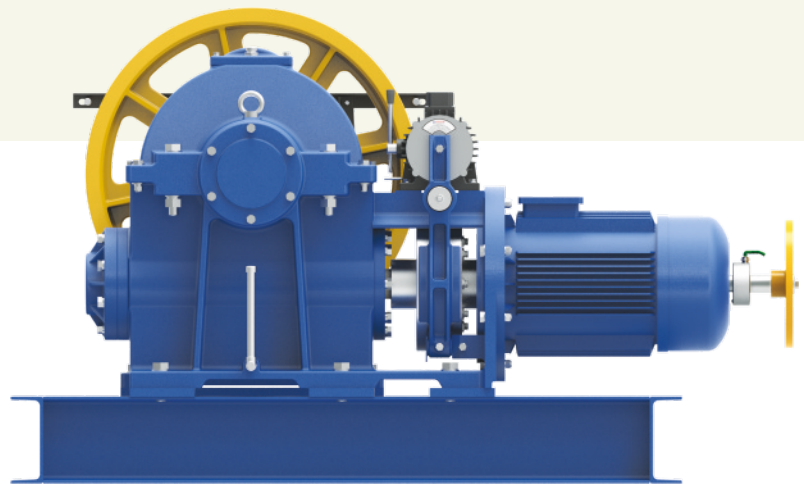

**Static Load (kg)**  
8200



**Gear Ratio**  
1/58



**Oil Capacity (Ltr)**  
25.0



**Brake Voltage (DC)**  
110V



**Weight of Machine (kg)**  
1290\*

\* Weight of machine is varies according to selection of sheave, Motor.

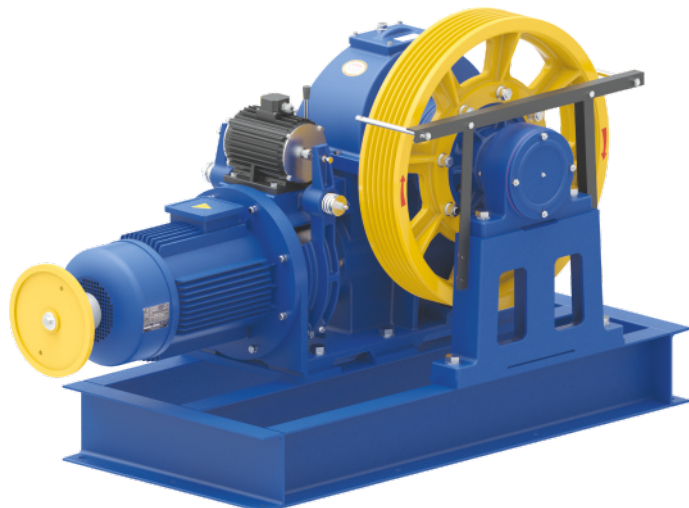



## Geared Traction Machine



Listed loads don't include the rope's weight.  
In order to know the net loads capacity, subtract rope's weight from the listed loads.

Position of the gearbox Up  
Counter weight 50%  
Plant efficiency 0.80

AC VVVF			400 V			50 Hz			Travelling : - 30 mtr	
Machine	Duty Load		Roping	Async. Speed	Ratio	Motor Detail		RPM	Rated Current	Sheave Specification
	Person	Kg		(m/sec)		(kw)	(HP)	(Async.)	(A)	Sheave Dia x Rope Dia. X No. of Groove
CAL - 250	4000	2:1	0.32	1/58	18.5	25.0	970	37.5	Ø 770 X 16mm X 5 Grv.	
			0.50	1/58	22.0	30.0	1440	43.0	Ø 770 X 16mm X 5 Grv.	
	5000	2:1	0.32	1/58	22.0	30.0	960	44.0	Ø 770 X 16mm X 6 Grv.	
			0.50	1/58	26.0	35.0	1440	49.5	Ø 770 X 16mm X 6 Grv.	

Kindly contact us for various speed and load combination

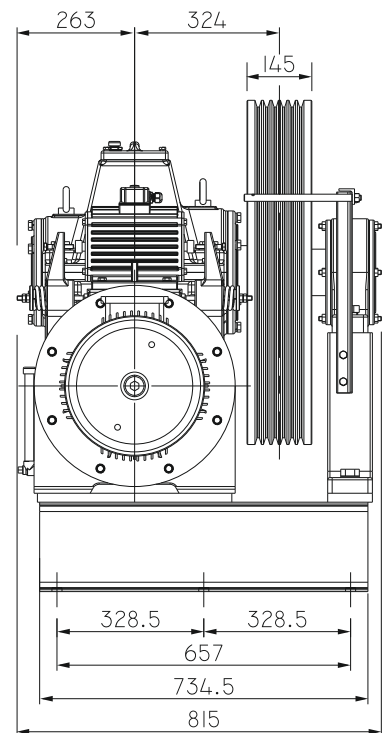
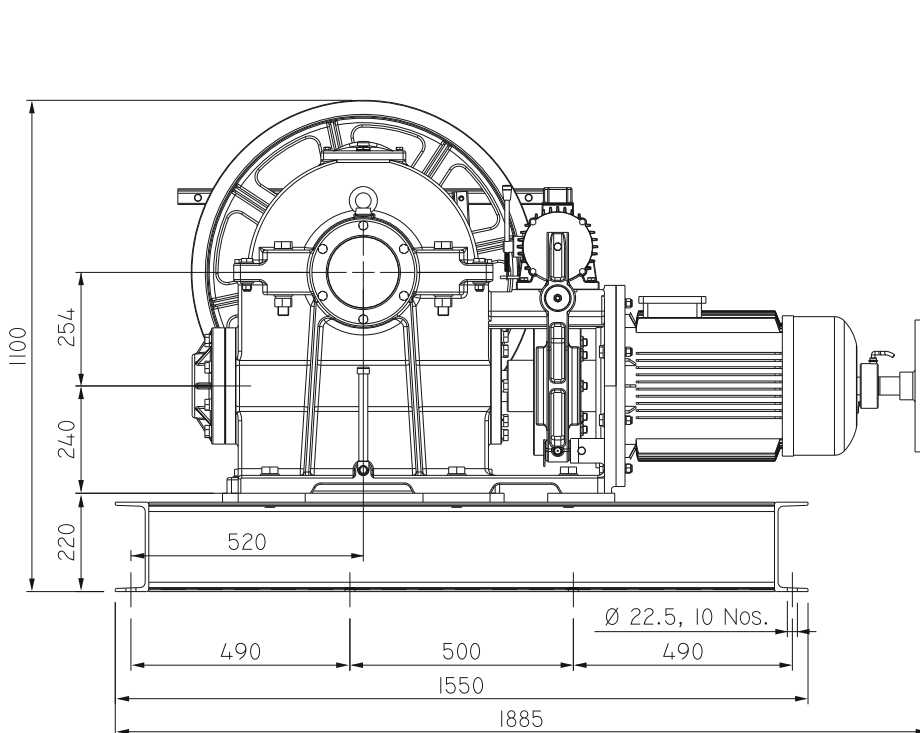

(All dimensions are in mm)

## CAULDRON SERIES

Geared Traction Machine

### Dumbwaiter HEN-06 Pulley Type

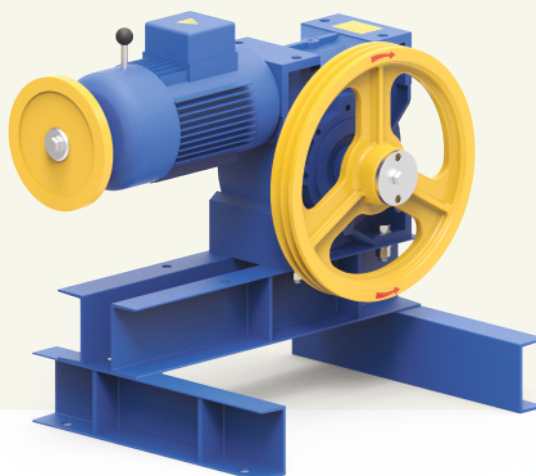

**Static Load (Kg)**  
700



**Gear Ratio**  
1/50



**Oil Capacity (Ltr)**  
1.0



**Brake Voltage (DC)**  
190V



**Weight of Machine (Kg)**  
125\*

\* Weight of machine is varies according to selection of sheave, Motor & Drive system.

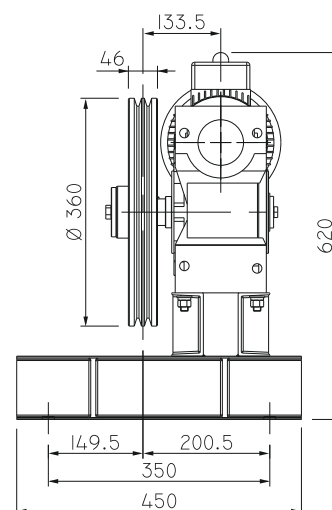
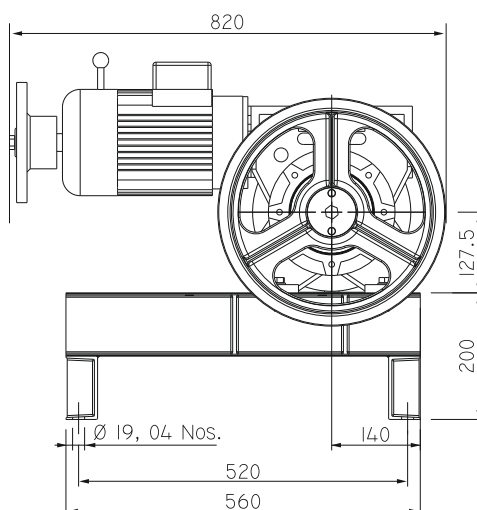

(All dimensions are in mm)

## Geared Traction Machine

Listed loads don't include the rope's weight.  
In order to know the net loads capacity, subtract rope's weight from the listed loads.

Position of the gearbox Up  
Counter weight 50%  
Plant efficiency 0.80

AC VVVF

415 V

50 Hz

Travelling : - 10 mtr

Machine	Duty Load		Roping	Async. Speed	Ratio	Motor Detail		RPM	Rated Current	Sheave Specification
	Person	(Kg)		(m/sec)		(Kw)	(HP)	(Async.)	(A)	Sheave Dia X Rope Dia. X No. of Groove
HEN - 06	250		1:1	0.50	1/50	2.2	3.0	1400	5.1	Ø 360 X 10mm X 2 Grv.





Kindly contact us for various speed and load combination

# CAULDRON SERIES

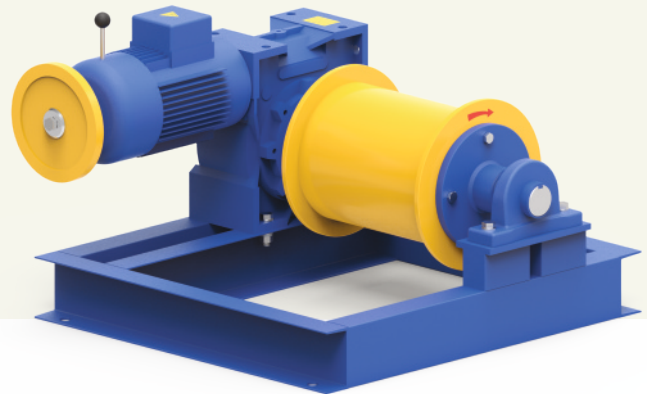
Geared Traction Machine

## Dumbwaiter HEN-06 Drum Type



-  **Static Load (Kg)**  
700
-  **Gear Ratio**  
1/50
-  **Oil Capacity (Ltr)**  
1.0
-  **Brake Voltage (DC)**  
190V
-  **Weight of Machine (Kg)**  
140\*

\* Weight of machine is varies according to selection of sheave, Motor & Drive system.

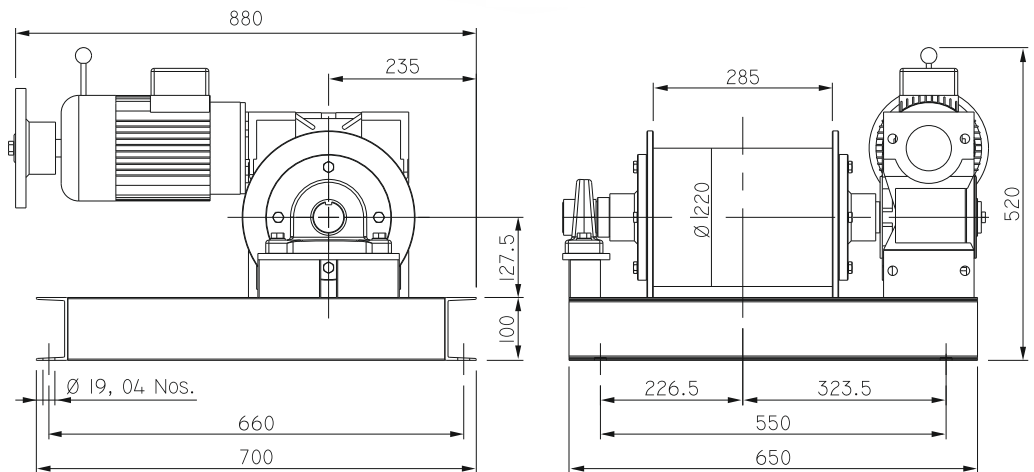

## Geared Traction Machine

Listed loads don't include the rope's weight.  
In order to know the net loads capacity, subtract rope's weight from the listed loads.

Position of the gearbox Up  
Counter weight 50%  
Plant efficiency 0.80

AC VVVF		415 V			50 Hz			Travelling : - 10 mtr		
Machine	Duty Load		Roping	Async. Speed	Ratio	Motor Detail		RPM	Rated Current	Sheave Specification
	Person	(Kg)		(m/sec)		(Kw)	(HP)	(Async.)	(A)	Sheave Dia X Rope Dia. X No. of Groove
HEN - 06	250		1:1	0.33	1/50	2.2	3.0	1400	5.1	Ø 220 X 10mm

Kindly contact us for various speed and load combination



## SERVICE OVERVIEW



Better Service for  
Satisfied Customers

As we say 'Elevating the Experience'  
we follow the same motto to provide  
service to all our OEM Partners.  
We are there 24 X 7 for all our partners.



FAST SERVICE



RELIABILITY



SAFETY



SERVICE



**SHARP**<sup>TM</sup>  
ENGINEERS

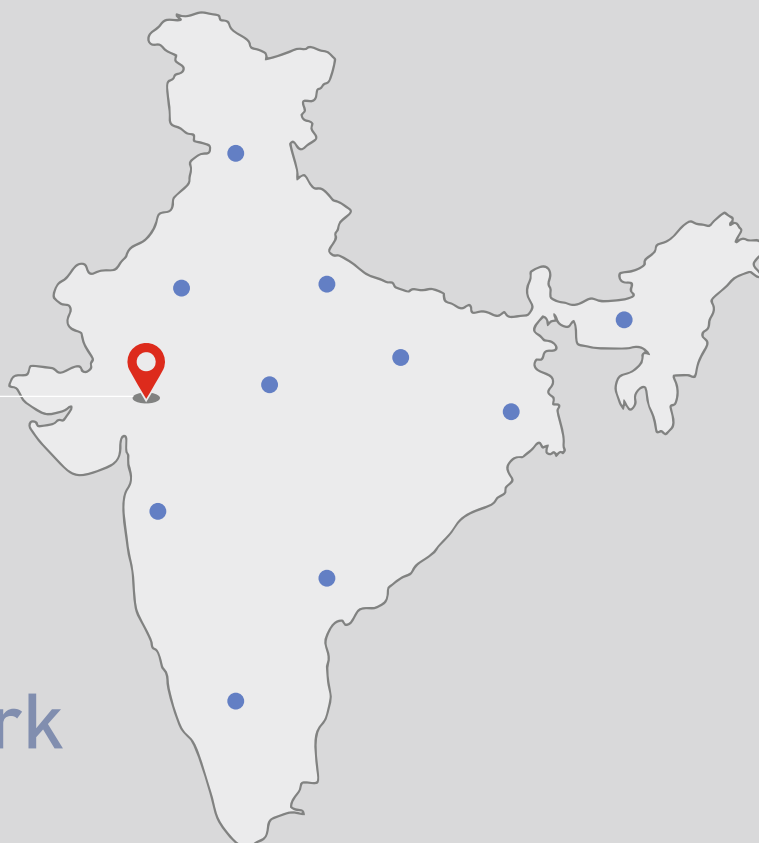

Technical Support by Well Built

**Service Network**





25

Global Presence Countries





SCAN ME



552, 'A' Road, Cross Road-12, G.I.D.C. Kathwada, Ahmedabad-382430. Gujarat, India. Phone : + 91 79 2290 1711, 12,14, 15.  
E-mail : [info@sharpengineers.com](mailto:info@sharpengineers.com) / [sales@sharpengineers.com](mailto:sales@sharpengineers.com) Website : [www.sharpengineers.com](http://www.sharpengineers.com)