

Static Load (Kg)
2200



Gear Ratio
1/37



Brake Voltage (DC)
110V, 220V



Oil Capacity (Ltr)
1.6



Weight of Machine (kg)
180* (With Bed Plate)*

* Weight of machine is varies according to selection of sheave, Motor & Drive system.

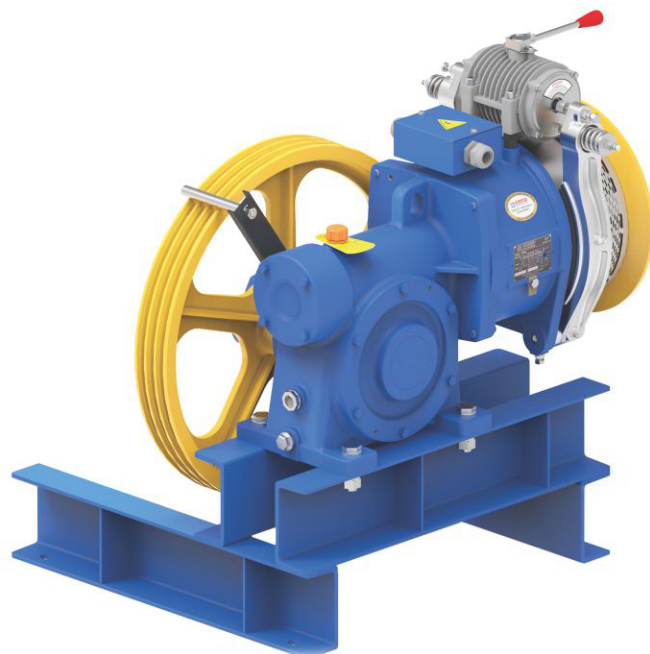

Geared Traction Machine



Listed loads don't include the rope's weight.
In order to know the net loads capacity, subtract rope's weight from the listed loads.

Position of the gearbox Up
Counter weight 50%
Plant efficiency 0.80

Machine	Duty Load		Roping	Async. Speed	Ratio	Motor Detail	RPM	Rated Current	Sheave Specification
	Person	Kg		(m/sec)		(kw)	(Async.)	(A)	Sheave Dia x Rope Dia. X No. of Groove
	STARK	6		408		1:1	1.00	1/37	4.0
				0.70	1/37	4.0	1430	9.0	Ø 320 X 8mm X 5 Grv.

Ø P	N X Ød	A	B	C	D	E
Ø530	3 X Ø13	65	168	233	267	205
Ø320	5 X Ø8	70	170.5	235.5	264.5	230

Kindly contact us for various speed and load combination

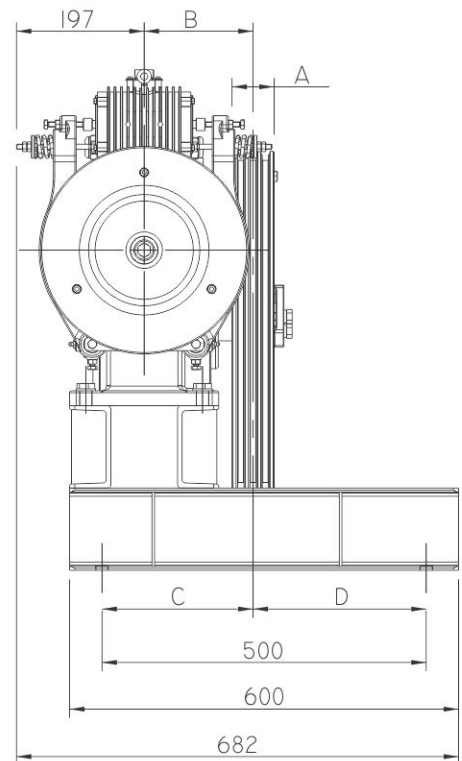
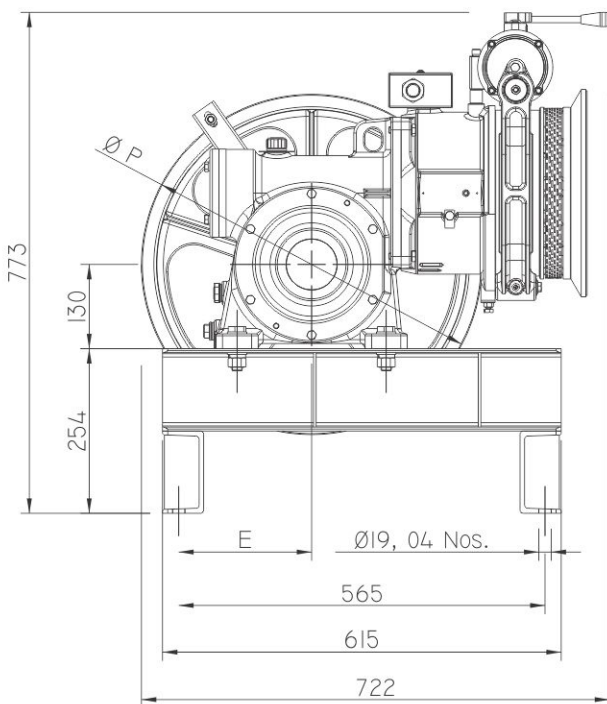

(All dimensions are in mm)