

SEG SERIES

Gearless Traction Machine

SEG-05S
FOR HOME LIFT



Voltage
230 V



Suspension
2:1



Brake
110 VDC



Max. Static Load
2000 Kg



Weight of Machine (kg)
117*

* Weight of machine is varies according to selection of sheave, Motor & Drive system.

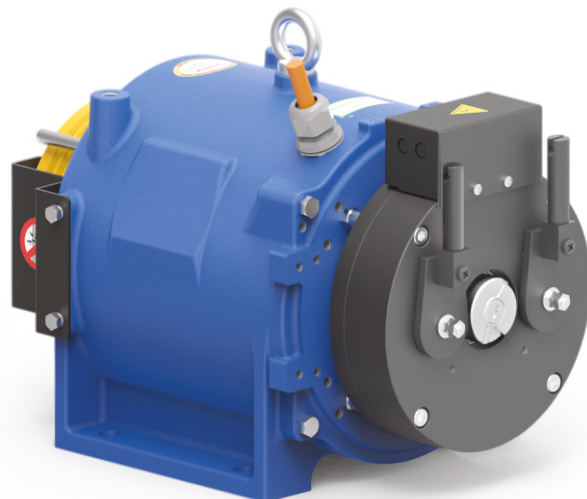

Gearless Traction Machine

SEG-05S
FOR HOME LIFT

Specification	Load (kg)	Lift Speed (m/s)	Height (m)	Sheave Dia (mm)	No. of Groove X Rope Dia	Current (A)	Toque (Nm)	Rated Speed (rpm)	Frequency (Hz)	Power (kW)	Pole	Rating	INS Class.	IP Code
S05S-4P0A3	272	0.32	≤ 20	Ø200	4 X Ø6	3.0	90	61	10.2	0.6	20	S5 (40%)	F Class	IP40
S05S-4P0A4		0.40			4 X Ø6	3.4	90	76	12.7	0.7				
S05S-4P0A5		0.50			4 X Ø6	3.7	90	96	15.9	0.9				
S05S-5P0A3	340	0.32	≤ 20	Ø200	4 X Ø6	4.0	110	61	10.2	0.7	20	S5 (40%)	F Class	IP40
S05S-5P0A4		0.40			4 X Ø6	4.2	110	76	12.7	0.9				
S05S-5P0A5		0.50			4 X Ø6	4.5	110	96	15.9	1.1				
S05S-6P0A3	408	0.32	≤ 20	Ø200	4 X Ø6	4.8	130	61	10.2	0.8	20	S5 (40%)	F Class	IP40
S05S-6P0A4		0.40			4 X Ø6	5.0	130	76	12.7	1.0				
S05S-6P0A5		0.50			4 X Ø6	5.2	130	96	15.9	1.3				

Kindly contact us for various speed and load combination

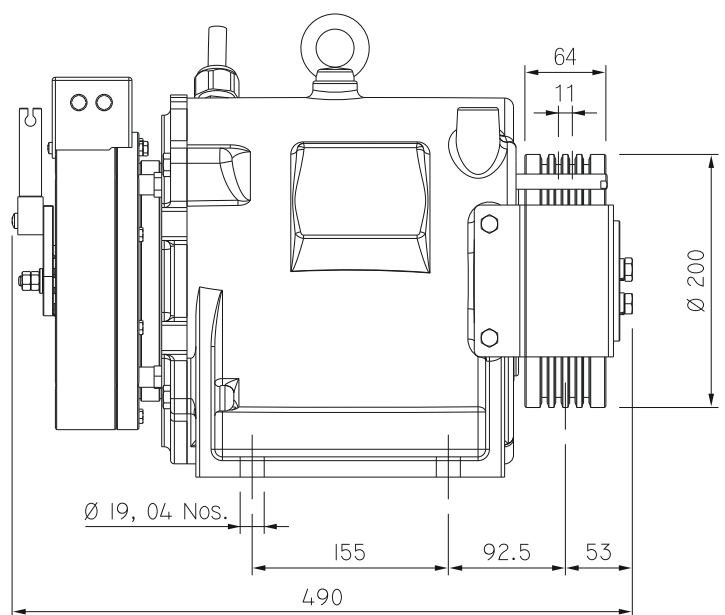
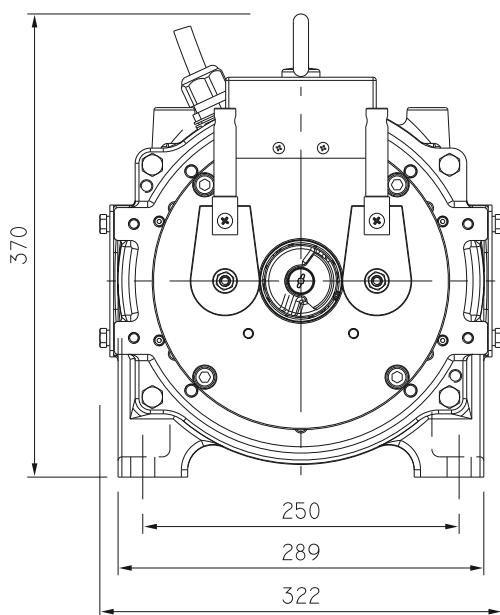

(All dimensions are in mm)