

# SEG SERIES

Gearless Traction Machine

**SEG**  $\beta$ 1  
Belt Drive

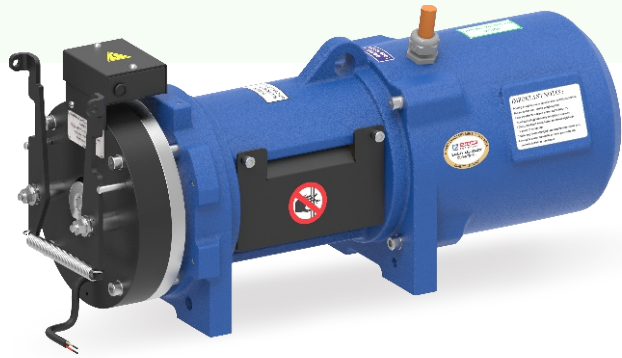

**Voltage**  
400 V



**Suspension**  
2:1



**Brake**  
110 VDC



**Max. Static Load**  
2000 Kg



**Weight of Machine (kg)**  
125\*

\* Weight of machine is varies according to selection of sheave, Motor & Drive system.



# Gearless Traction Machine

## SEG $\beta$ 1 Belt Drive

Specification	Load (kg)	Lift Speed (m/s)	Sheave Dia (mm)	Belt Detail (n X D)	Current (A)	Toque (Nm)	Rated Speed (rpm)	Frequency (Hz)	Power (kW)
S $\beta$ 1- 6P1A0	408	1.00	110	3 X 30	8.0	85	348	34.8	3.0
S $\beta$ 1- 6P1A6		1.60		3 X 30	10.2	85	556	55.6	4.9
S $\beta$ 1- 8P1A0	544	1.00	110	3 X 30	9.8	110	348	34.8	4.0
S $\beta$ 1- 8P1A6		1.60		3 X 30	11.8	110	556	55.6	6.3
S $\beta$ 2 - 10P1A0	680	1.00	110	3 X 30	11.8	140	348	34.8	5.0
S $\beta$ 2 - 10P1A6		1.60		3 X 30	15.2	140	556	55.6	8.0
S $\beta$ 2 - 13P1A0	884	1.00	110	4 X 30	13.0	180	348	34.8	6.5
S $\beta$ 2 - 13P1A6		1.60		4 X 30	17.5	180	556	55.6	10.3
S $\beta$ 3 - 16P1A0	1088	1.00	110	5 X 30	16.0	220	348	34.8	7.9
S $\beta$ 3 - 16P1A6		1.60		5 X 30	21.5	220	556	55.6	12.7

Kindly contact us for various speed and load combination

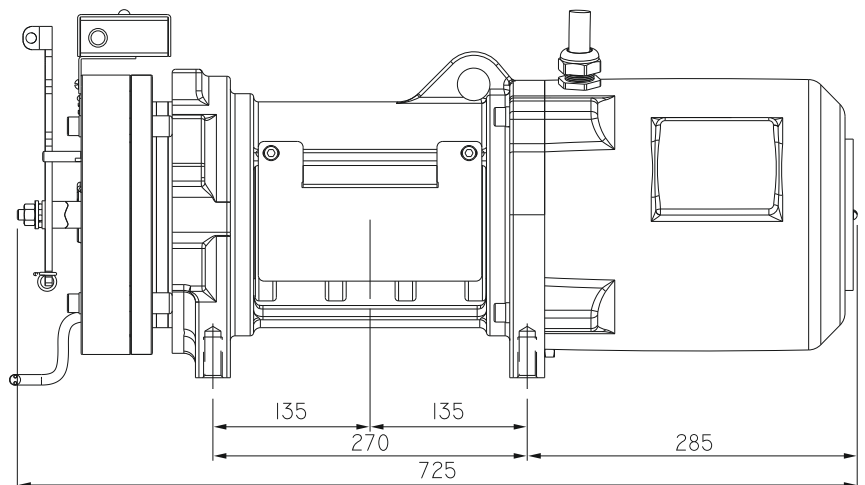
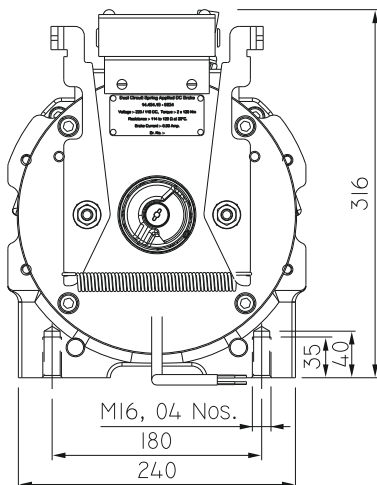

\* Kindly contact sales team for G.A. drawing of SEG-B2 & SEG-B3

(All dimensions are in mm)